

## Kordelgriffe

### ELESA-standards

Kunststoff

Thermoplast verstärkt  
schwarz , matt  
schlagfest  
temperaturbeständig bis 75° C

Buchse Messing

Form A: metrisches Gewinde  
Form B: Bohrung



Nr. 04 479

Bestellbeispiel

04479.A50XM10

Form            A  
d 1            50  
d 2            M 10

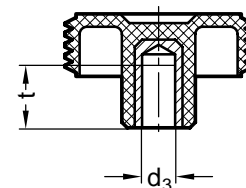
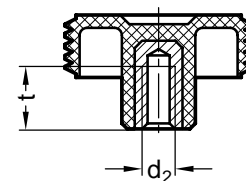

d <sub>1</sub>	d <sub>2</sub>	d <sub>3</sub> H9	d <sub>4</sub>	h <sub>1</sub>	h <sub>2</sub>	t
32	M 5	-	15	22	9	10
32	M 6	-	15	22	9	12
40	M 6	B 6	17	24	11	12
40	M 8	-	17	24	11	13
50	M 8	B 8	20	30	13,5	13
50	M 10	-	20	30	13,5	17
60	M 10	B 10	23	35	15	17
60	M 12	-	23	35	15	20
70	M 12	-	24	38	18,5	20
70	M 14	-	24	38	18,5	20