

Kreuzgriffe, DIN-6335, Kunststoff Thermoplast, schwarz, mit Gewindebuchse



Kreuzgriffe DIN 6335

Kunststoff (KT)

Thermoplast/Polyamid
schwarz, matt

Form K: mit Gewindebuchse

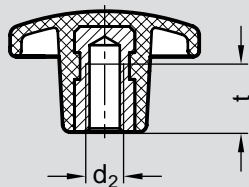
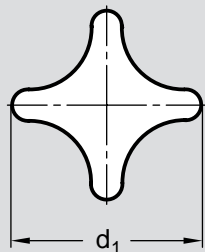
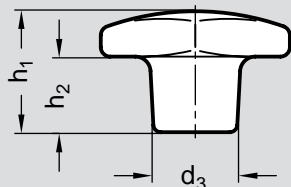

Nr. 04 465

Bestellbeispiel

04465.K40XM08

Form	K
d 1	40
d 2	M 08

d ₁	d ₂	d ₃	h ₁	h ₂	t
32	M 6	14	20	10	12
40	M 8	18	25	13	14
50	M 10	22	32	20	18
63	M 12	26	40	25	22
80	M 16	35	50	30	30