

G110-08M

OEM Parallel Grippers | Dimensions and Technical Specifications

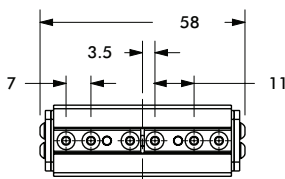

| Specifications | Units | 08M |
|----------------------------------|-----------|----------------------|
| Total Rated Grip Force | N [lbf] | 56 [13] |
| Pressure Range | bar [psi] | 3-7 [40-100] |
| Cylinder Bore Diameter | mm [in] | 8 [0.31] |
| Temperature Range (Buna-N Seals) | °C [°F] | -35°~80° [-30°~180°] |
| Accuracy | mm [in] | ±.05 [0.002] |
| Repeatability | mm [in] | ±.05 [0.002] |
| Valve Required to Actuate | | 4 way 2 position |

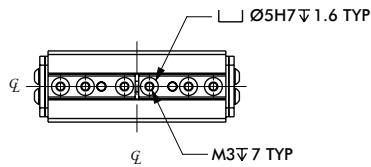
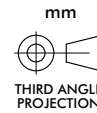
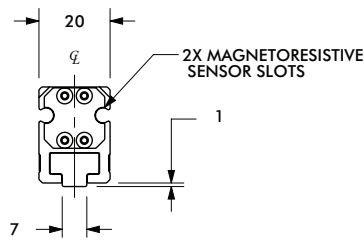
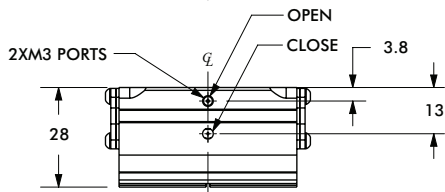
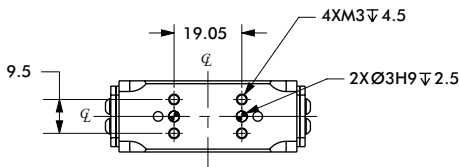

G110-08M-10

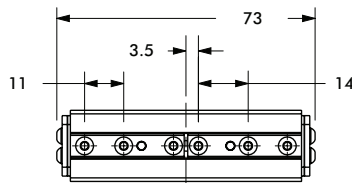

G110-08M-15

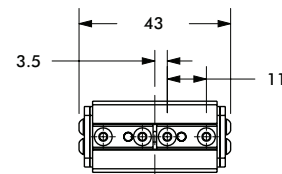

G110-08M-05

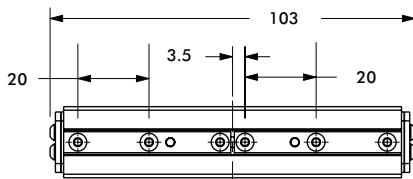

G110-08M-25

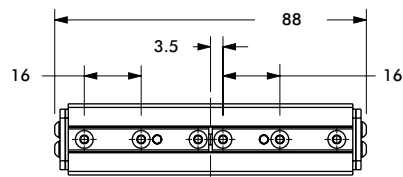

G110-08M-20

Dimensions and technical information are subject to change without notice

G110-08M

OEM Parallel Grippers | Technical Specifications

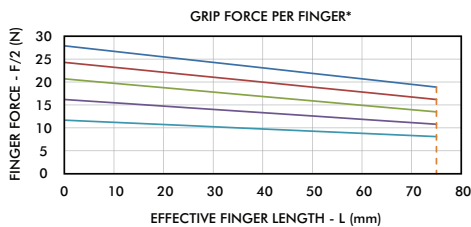
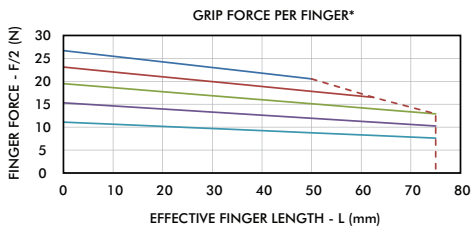
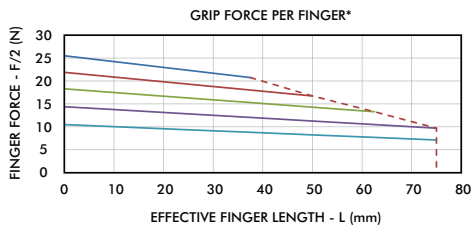
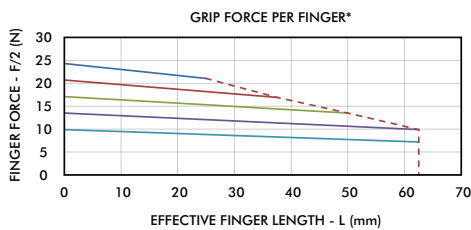
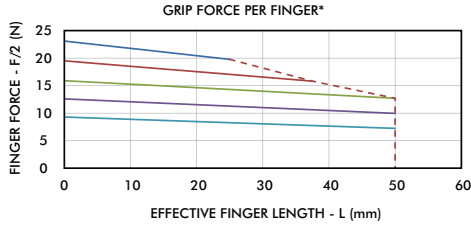

- 7 bar (102 psi)
- 6 bar (87 psi)
- 5 bar (73 psi)
- 4 bar (58 psi)
- 3 bar (44 psi)
- - - MAX FINGER LENGTH

Dimensions and technical information are subject to change without notice

| Specifications | Units | 08M-05 |
|------------------------------|-------------|-------------|
| Stroke | mm [in] | 5 [0.20] |
| Weight | kg [lbs] | 0.06 [0.13] |
| Displacement | cc [cu-in] | 0.3 [0.02] |
| Actuation (open/close) | sec. | 0.06 |
| Max Tensile Load on Jaws | N [lbf] | 156 [35] |
| Max Compressive Load on Jaws | N [lbf] | 356 [80] |
| Max Moment on Jaws | Nm [in-lbs] | 3.4 [30] |

| Specifications | Units | 08M-10 |
|------------------------------|-------------|-------------|
| Stroke | mm [in] | 10 [0.39] |
| Weight | kg [lbs] | 0.09 [0.20] |
| Displacement | cc [cu-in] | 0.5 [0.03] |
| Actuation (open/close) | sec. | 0.07 |
| Max Tensile Load on Jaws | N [lbf] | 178 [40] |
| Max Compressive Load on Jaws | N [lbf] | 378 [86] |
| Max Moment on Jaws | Nm [in-lbs] | 4 [35] |

| Specifications | Units | 08M-15 |
|------------------------------|-------------|-------------|
| Stroke | mm [in] | 15 [0.59] |
| Weight | kg [lbs] | 0.11 [0.24] |
| Displacement | cc [cu-in] | 0.7 [0.05] |
| Actuation (open/close) | sec. | 0.08 |
| Max Tensile Load on Jaws | N [lbf] | 200 [45] |
| Max Compressive Load on Jaws | N [lbf] | 400 [90] |
| Max Moment on Jaws | Nm [in-lbs] | 4.6 [40] |

| Specifications | Units | 08M-20 |
|------------------------------|-------------|-------------|
| Stroke | mm [in] | 20 [0.79] |
| Weight | kg [lbs] | 0.14 [0.31] |
| Displacement | cc [cu-in] | 1.0 [0.06] |
| Actuation (open/close) | sec. | 0.09 |
| Max Tensile Load on Jaws | N [lbf] | 222 [50] |
| Max Compressive Load on Jaws | N [lbf] | 423 [95] |
| Max Moment on Jaws | Nm [in-lbs] | 5.0 [45] |

| Specifications | Units | 08M-25 |
|------------------------------|-------------|-------------|
| Stroke | mm [in] | 25 [0.98] |
| Weight | kg [lbs] | 0.17 [0.37] |
| Displacement | cc [cu-in] | 1.2 [0.08] |
| Actuation (open/close) | sec. | 0.10 |
| Max Tensile Load on Jaws | N [lbf] | 245 [55] |
| Max Compressive Load on Jaws | N [lbf] | 445 [100] |
| Max Moment on Jaws | Nm [in-lbs] | 5.6 [50] |

G110-11M

OEM Parallel Grippers | Dimensions and Technical Specifications



| Specifications | Units | 11M |
|----------------------------------|-----------|----------------------|
| Total Rated Grip Force | N [lbf] | 104 [23] |
| Pressure Range | bar [psi] | 3-7 [40-100] |
| Cylinder Bore Diameter | mm [in] | 11 [0.44] |
| Temperature Range (Buna-N Seals) | °C [°F] | -35°~80° [-30°~180°] |
| Accuracy | mm [in] | ±.05 [0.002] |
| Repeatability | mm [in] | ±.05 [0.002] |
| Valve Required to Actuate | | 4 way 2 position |

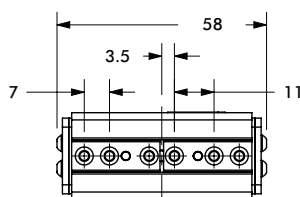
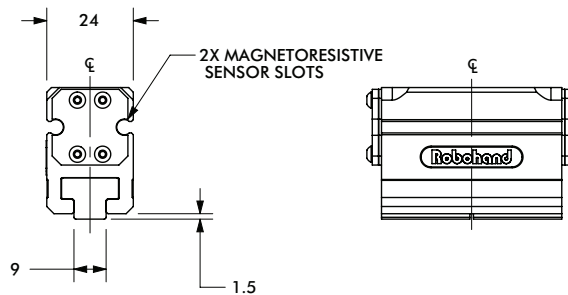
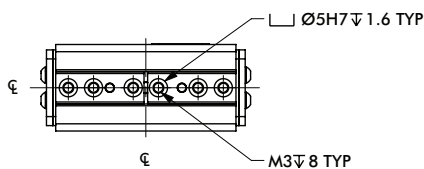
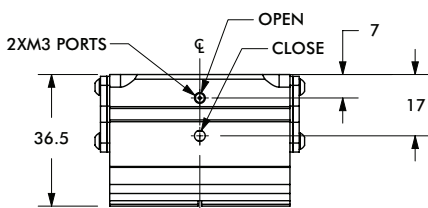
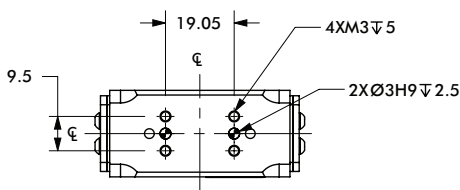

G110-11M-10

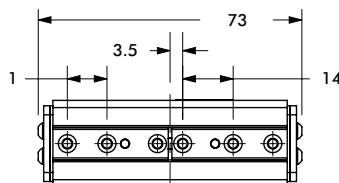

G110-11M-15

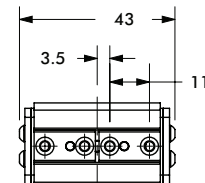

G110-11M-05

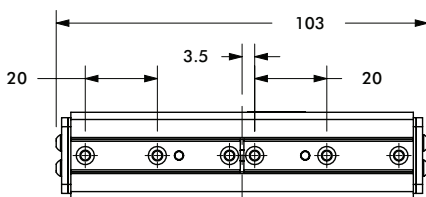

G110-11M-25

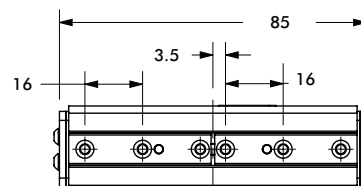

G110-11M-20

Dimensions and technical information are subject to change without notice

G110-11M

OEM Parallel Grippers | Technical Specifications

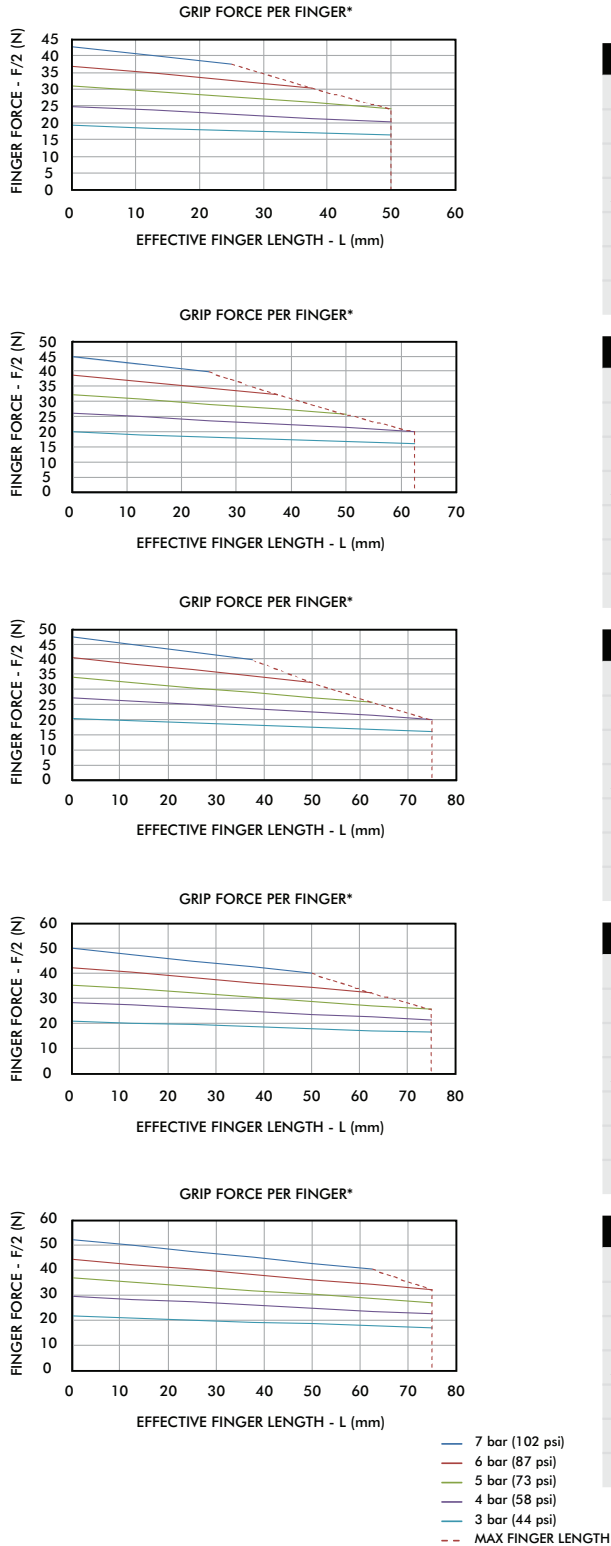

Dimensions and technical information are subject to change without notice

| Specifications | Units | 11M-05 |
|------------------------------|-------------|-------------|
| Stroke | mm [in] | 5 [0.20] |
| Weight | kg [lbs] | 0.09 [0.20] |
| Displacement | cc [cu-in] | 0.5 [0.03] |
| Actuation (open/close) | sec. | 0.08 |
| Max Tensile Load on Jaws | N [lbf] | 311 [70] |
| Max Compressive Load on Jaws | N [lbf] | 712 [160] |
| Max Moment on Jaws | Nm [in-lbs] | 7 [60] |

| Specifications | Units | 11M-10 |
|------------------------------|-------------|-------------|
| Stroke | mm [in] | 10 [0.39] |
| Weight | kg [lbs] | 0.13 [0.29] |
| Displacement | cc [cu-in] | 1.0 [0.06] |
| Actuation (open/close) | sec. | 0.09 |
| Max Tensile Load on Jaws | N [lbf] | 350 [80] |
| Max Compressive Load on Jaws | N [lbf] | 750 [170] |
| Max Moment on Jaws | Nm [in-lbs] | 8 [70] |

| Specifications | Units | 11M-15 |
|------------------------------|-------------|-------------|
| Stroke | mm [in] | 15 [0.59] |
| Weight | kg [lbs] | 0.17 [0.37] |
| Displacement | cc [cu-in] | 1.5 [0.09] |
| Actuation (open/close) | sec. | 0.10 |
| Max Tensile Load on Jaws | N [lbf] | 400 [90] |
| Max Compressive Load on Jaws | N [lbf] | 800 [180] |
| Max Moment on Jaws | Nm [in-lbs] | 9 [80] |

| Specifications | Units | 11M-20 |
|------------------------------|-------------|-------------|
| Stroke | mm [in] | 20 [0.79] |
| Weight | kg [lbs] | 0.21 [0.46] |
| Displacement | cc [cu-in] | 1.9 [0.12] |
| Actuation (open/close) | sec. | 0.11 |
| Max Tensile Load on Jaws | N [lbf] | 445 [100] |
| Max Compressive Load on Jaws | N [lbf] | 845 [190] |
| Max Moment on Jaws | Nm [in-lbs] | 10 [90] |

| Specifications | Units | 11M-25 |
|------------------------------|-------------|-------------|
| Stroke | mm [in] | 25 [0.98] |
| Weight | kg [lbs] | 0.25 [0.55] |
| Displacement | cc [cu-in] | 1.2 [0.15] |
| Actuation (open/close) | sec. | 0.12 |
| Max Tensile Load on Jaws | N [lbf] | 490 [110] |
| Max Compressive Load on Jaws | N [lbf] | 890 [200] |
| Max Moment on Jaws | Nm [in-lbs] | 11 [100] |

G110-18M

OEM Parallel Grippers | Dimensions and Technical Specifications



| Specifications | Units | 18M |
|----------------------------------|-----------|----------------------|
| Total Rated Grip Force | N [lbf] | 260 [58] |
| Pressure Range | bar [psi] | 3-7 [40-100] |
| Cylinder Bore Diameter | mm [in] | 17.5 [0.69] |
| Temperature Range (Buna-N Seals) | °C [°F] | -35°~80° [-30°~180°] |
| Accuracy | mm [in] | ±.05 [0.002] |
| Repeatability | mm [in] | ±.05 [0.002] |
| Valve Required to Actuate | | 4 way 2 position |

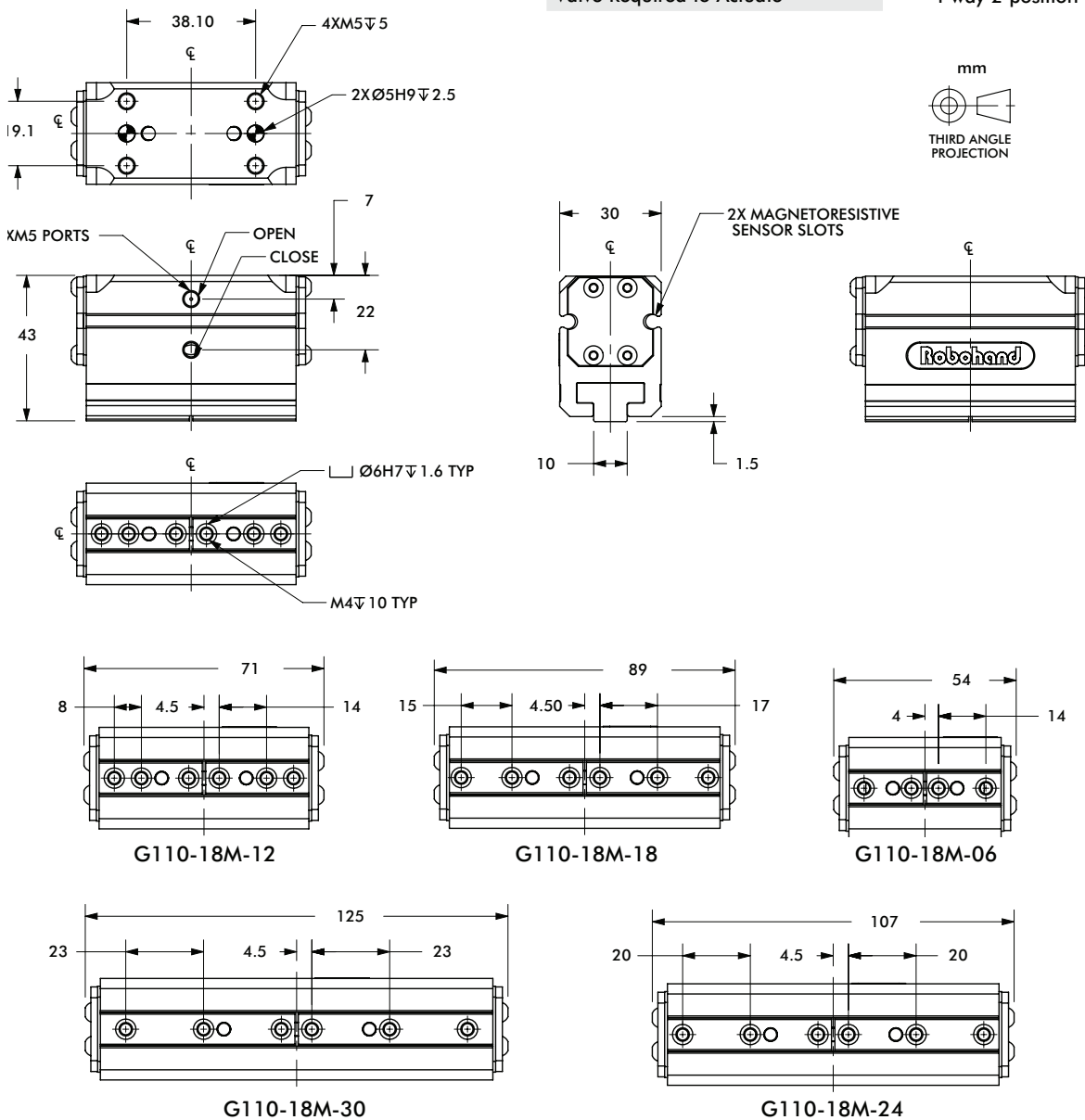

Dimensions and technical information are subject to change without notice

G110-18M

OEM Parallel Grippers | Technical Specifications

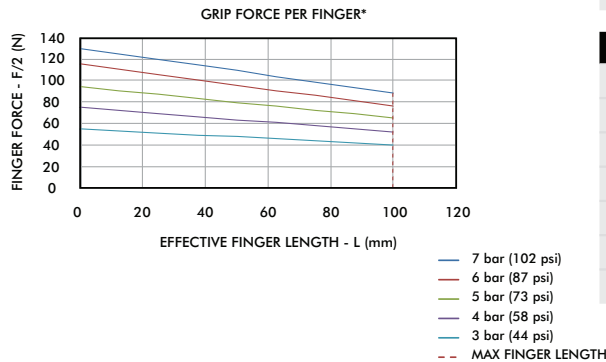
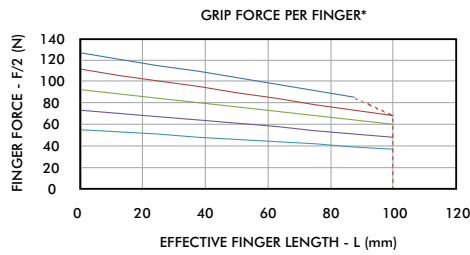
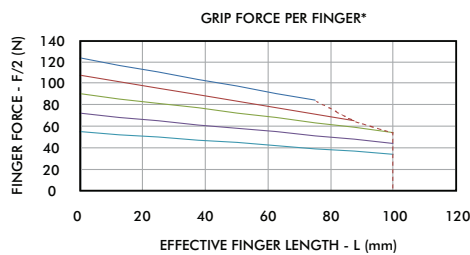
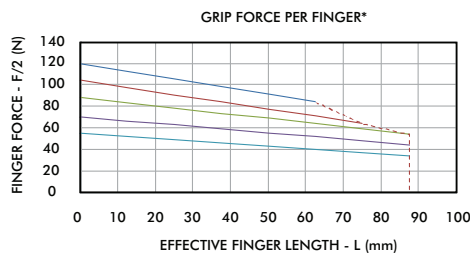
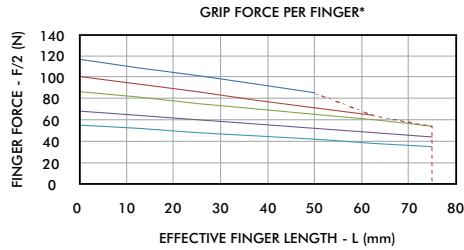

Dimensions and technical information are subject to change without notice

| Specifications | Units | 18M-06 |
|------------------------------|-------------|-------------|
| Stroke | mm [in] | 6 [0.24] |
| Weight | kg [lbs] | 0.20 [0.44] |
| Displacement | cc [cu-in] | 1.5 [0.09] |
| Actuation (open/close) | sec. | 0.09 |
| Max Tensile Load on Jaws | N [lbf] | 778 [175] |
| Max Compressive Load on Jaws | N [lbf] | 1779 [400] |
| Max Moment on Jaws | Nm [in-lbs] | 17 [150] |

| Specifications | Units | 18M-12 |
|------------------------------|-------------|-------------|
| Stroke | mm [in] | 12 [0.47] |
| Weight | kg [lbs] | 0.22 [0.48] |
| Displacement | cc [cu-in] | 2.9 [0.18] |
| Actuation (open/close) | sec. | 0.13 |
| Max Tensile Load on Jaws | N [lbf] | 890 [200] |
| Max Compressive Load on Jaws | N [lbf] | 1890 [425] |
| Max Moment on Jaws | Nm [in-lbs] | 20 [175] |

| Specifications | Units | 18M-18 |
|------------------------------|-------------|-------------|
| Stroke | mm [in] | 18 [0.71] |
| Weight | kg [lbs] | 0.28 [0.62] |
| Displacement | cc [cu-in] | 4.3 [0.26] |
| Actuation (open/close) | sec. | 0.17 |
| Max Tensile Load on Jaws | N [lbf] | 1000 [225] |
| Max Compressive Load on Jaws | N [lbf] | 2000 [450] |
| Max Moment on Jaws | Nm [in-lbs] | 23 [200] |

| Specifications | Units | 18M-24 |
|------------------------------|-------------|-------------|
| Stroke | mm [in] | 24 [0.94] |
| Weight | kg [lbs] | 0.34 [0.75] |
| Displacement | cc [cu-in] | 5.8 [0.35] |
| Actuation (open/close) | sec. | 0.21 |
| Max Tensile Load on Jaws | N [lbf] | 1112 [250] |
| Max Compressive Load on Jaws | N [lbf] | 2113 [475] |
| Max Moment on Jaws | Nm [in-lbs] | 25 [225] |

| Specifications | Units | 18M-30 |
|------------------------------|-------------|-------------|
| Stroke | mm [in] | 30 [1.18] |
| Weight | kg [lbs] | 0.41 [0.90] |
| Displacement | cc [cu-in] | 7.2 [0.44] |
| Actuation (open/close) | sec. | 0.25 |
| Max Tensile Load on Jaws | N [lbf] | 1223 [275] |
| Max Compressive Load on Jaws | N [lbf] | 2225 [500] |
| Max Moment on Jaws | Nm [in-lbs] | 28 [250] |

G110-25M

OEM Parallel Grippers | Dimensions and Technical Specifications



| Specifications | Units | 25M |
|----------------------------------|-----------|----------------------|
| Total Rated Grip Force | N [lbf] | 558 [125] |
| Pressure Range | bar [psi] | 3-7 [40-100] |
| Cylinder Bore Diameter | mm [in] | 25 [1.00] |
| Temperature Range (Buna-N Seals) | °C [°F] | -35°~80° [-30°~180°] |
| Accuracy | mm [in] | ±.05 [0.002] |
| Repeatability | mm [in] | ±.05 [0.002] |
| Valve Required to Actuate | | 4 way 2 position |

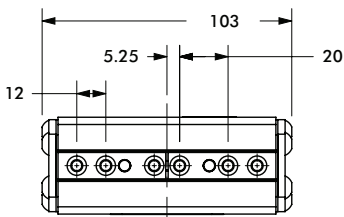
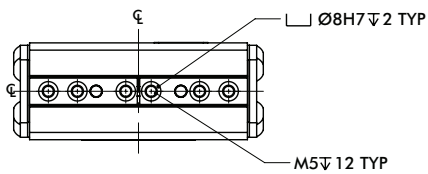
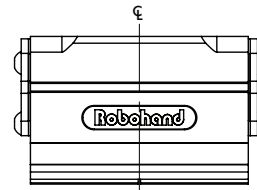
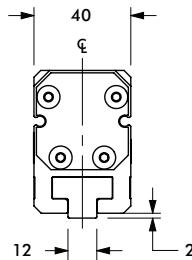
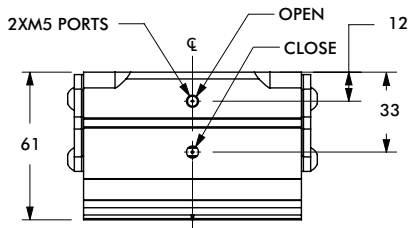
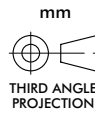
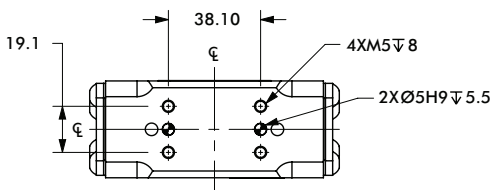

G110-25M-20

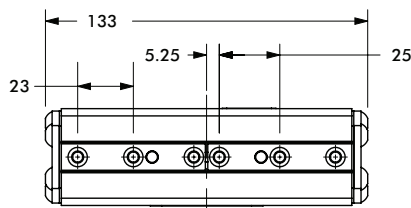

G110-25M-30

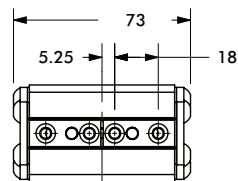

G110-25M-10

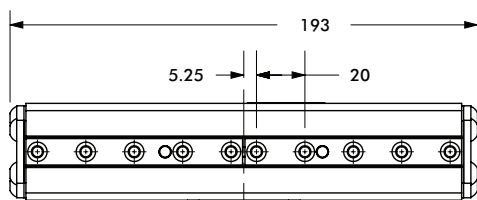

G110-25M-50

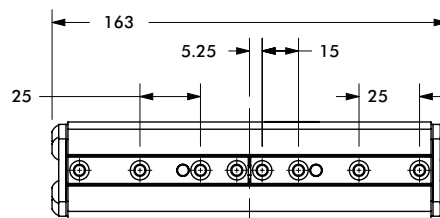

G110-25M-40

Dimensions and technical information are subject to change without notice

G110-25M

OEM Parallel Grippers | Technical Specifications

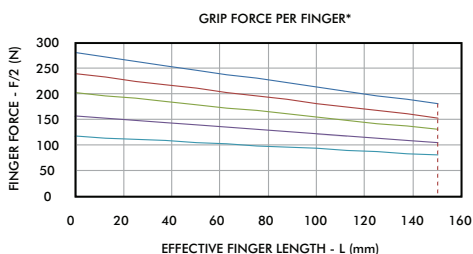
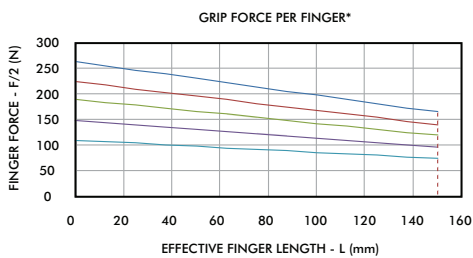
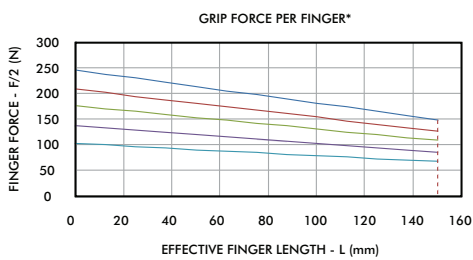
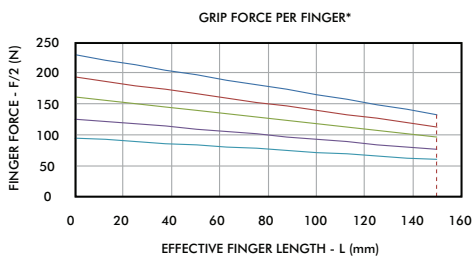
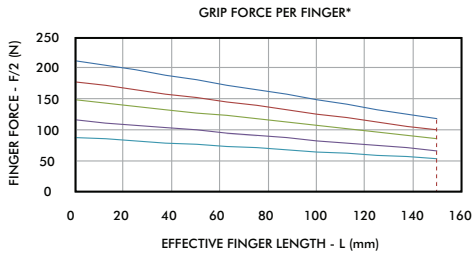

- 7 bar (102 psi)
- 6 bar (87 psi)
- 5 bar (73 psi)
- 4 bar (58 psi)
- 3 bar (44 psi)
- - MAX FINGER LENGTH

| Specifications | Units | 25M-10 |
|------------------------------|-------------|-------------|
| Stroke | mm [in] | 10 [0.39] |
| Weight | kg [lbs] | 0.42 [0.92] |
| Displacement | cc [cu-in] | 5.06 [0.31] |
| Actuation (open/close) | sec. | 0.28 |
| Max Tensile Load on Jaws | N [lbf] | 1550 [350] |
| Max Compressive Load on Jaws | N [lbf] | 3550 [800] |
| Max Moment on Jaws | Nm [in-lbs] | 35 [300] |

| Specifications | Units | 25M-20 |
|------------------------------|-------------|--------------|
| Stroke | mm [in] | 20 [0.79] |
| Weight | kg [lbs] | 0.64 [1.41] |
| Displacement | cc [cu-in] | 10.12 [0.62] |
| Actuation (open/close) | sec. | 0.36 |
| Max Tensile Load on Jaws | N [lbf] | 1750 [400] |
| Max Compressive Load on Jaws | N [lbf] | 3775 [850] |
| Max Moment on Jaws | Nm [in-lbs] | 40 [350] |

| Specifications | Units | 25M-30 |
|------------------------------|-------------|--------------|
| Stroke | mm [in] | 30 [1.18] |
| Weight | kg [lbs] | 0.85 [1.87] |
| Displacement | cc [cu-in] | 15.19 [0.93] |
| Actuation (open/close) | sec. | 0.44 |
| Max Tensile Load on Jaws | N [lbf] | 2000 [450] |
| Max Compressive Load on Jaws | N [lbf] | 4000 [900] |
| Max Moment on Jaws | Nm [in-lbs] | 45 [400] |

| Specifications | Units | 25M-40 |
|------------------------------|-------------|-------------|
| Stroke | mm [in] | 40 [1.57] |
| Weight | kg [lbs] | 1.03 [2.27] |
| Displacement | cc [cu-in] | 20.3 [1.24] |
| Actuation (open/close) | sec. | 0.52 |
| Max Tensile Load on Jaws | N [lbf] | 2225 [500] |
| Max Compressive Load on Jaws | N [lbf] | 4225 [950] |
| Max Moment on Jaws | Nm [in-lbs] | 50 [450] |

| Specifications | Units | 25M-50 |
|------------------------------|-------------|--------------|
| Stroke | mm [in] | 50 [1.97] |
| Weight | kg [lbs] | 1.22 [2.68] |
| Displacement | cc [cu-in] | 25.31 [1.55] |
| Actuation (open/close) | sec. | 0.61 |
| Max Tensile Load on Jaws | N [lbf] | 2450 [550] |
| Max Compressive Load on Jaws | N [lbf] | 4450 [1000] |
| Max Moment on Jaws | Nm [in-lbs] | 55 [500] |

Dimensions and technical information are subject to change without notice