

## EH 24790.

### Hohe Rändelschrauben

DIN 464

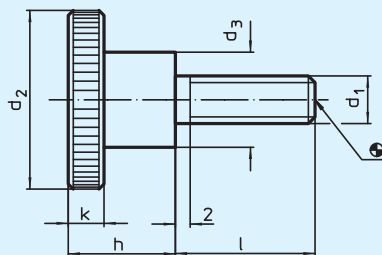

#### Werkstoff:

- Stahl, Güte 5.8, brüniert
- Rostfreier Stahl 1.4305, matt gestrahlt

#### Hinweis:

Rändelschrauben sind aus einem Stück hergestellt. Entgegen dem Normblatt sind sie generell mit Gewinde bis zum Kopf und ohne Einstich am Gewindeende gefertigt.

Best.-Nr. Stahl	Best.-Nr. Rostfreier Stahl	d <sub>1</sub>	l	d <sub>2</sub>	d <sub>3</sub>	h	k	g
24790.0074	24790.0274	M 3	6	12	6	7,5	2,5	3,7
24790.0076	24790.0276	M 3	10	12	6	7,5	2,5	3,8
24790.0077	24790.0277	M 3	12	12	6	7,5	2,5	4,0
24790.0079	24790.0279	M 3	16	12	6	7,5	2,5	4,0
24790.0092	–	M 4	5	16	8	9,5	3,5	7,7
24790.0094	24790.0294	M 4	8	16	8	9,5	3,5	7,9
24790.0095	24790.0295	M 4	10	16	8	9,5	3,5	8,1
24790.0096	24790.0296	M 4	12	16	8	9,5	3,5	8,3
24790.0098	24790.0298	M 4	16	16	8	9,5	3,5	8,4
24790.0100	24790.0300	M 4	20	16	8	9,5	3,5	9,1
24790.0102	24790.0302	M 4	25	16	8	9,5	3,5	9,0
24790.0112	–	M 5	6	20	10	11,5	4,0	14,0
24790.0113	–	M 5	8	20	10	11,5	4,0	15,0
24790.0114	24790.0314	M 5	10	20	10	11,5	4,0	15,0
24790.0115	24790.0315	M 5	12	20	10	11,5	4,0	15,0
24790.0117	24790.0317	M 5	16	20	10	11,5	4,0	16,0
24790.0119	24790.0319	M 5	20	20	10	11,5	4,0	16,0
24790.0121	24790.0321	M 5	25	20	10	11,5	4,0	17,0
24790.0123	24790.0323	M 5	30	20	10	11,5	4,0	17,0
24790.0132	–	M 6	8	24	12	15,0	5,0	28,0
24790.0133	–	M 6	10	24	12	15,0	5,0	27,0
24790.0134	24790.0334	M 6	12	24	12	15,0	5,0	28,0
24790.0136	24790.0336	M 6	16	24	12	15,0	5,0	28,0
24790.0138	24790.0338	M 6	20	24	12	15,0	5,0	29,0
24790.0140	24790.0340	M 6	25	24	12	15,0	5,0	30,0
24790.0142	24790.0342	M 6	30	24	12	15,0	5,0	31,0
24790.0144	24790.0344	M 6	35	24	12	15,0	5,0	31,0
24790.0152	–	M 8	12	30	16	18,0	6,0	53,0
24790.0154	24790.0354	M 8	16	30	16	18,0	6,0	55,0
24790.0156	24790.0356	M 8	20	30	16	18,0	6,0	56,0
24790.0158	24790.0358	M 8	25	30	16	18,0	6,0	58,0
24790.0160	24790.0360	M 8	30	30	16	18,0	6,0	60,0
24790.0162	24790.0362	M 8	35	30	16	18,0	6,0	60,0
24790.0164	–	M 8	40	30	16	18,0	6,0	61,0
24790.0173	–	M 10	20	36	20	23,0	8,0	106,0
24790.0175	–	M 10	25	36	20	23,0	8,0	109,0
24790.0177	–	M 10	30	36	20	23,0	8,0	112,0
24790.0179	–	M 10	35	36	20	23,0	8,0	116,0
24790.0181	–	M 10	40	36	20	23,0	8,0	116,0