

LS – 31

Zugfeste Gussrohrkupplung

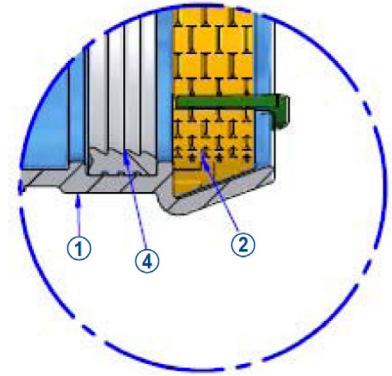
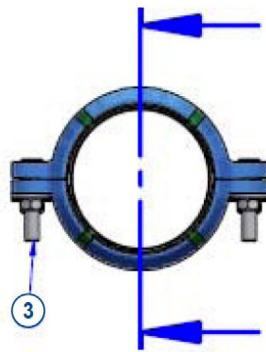
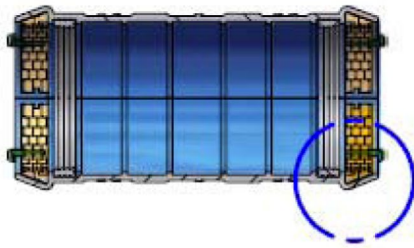
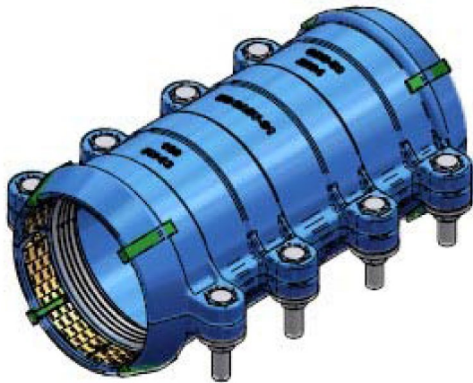

Referenz-Nr.	Durchmesser Rohr mm	Rohrlänge mm	Nutzlänge mm
LS-31-063	63	304	172
LS-31-075	75	304	172
LS-31-090	90	304	172
LS-31-110	110	304	172
LS-31-125	125	354	222
LS-31-140	140	354	222
LS-31-160	160	408	272
LS-31-180	180	408	272
LS-31-200	200	424	272

Nr.	Elemente	Material	Beschichtung	Norm
1	Schelle	GGG-50	250 µ Epoxy	EN 1514, EN 1563, BS 6920
2	Ring	F-114	Chrom	
3	Schrauben- verbindung	F-114, 6.8	GEOMET	DIN 931, DIN 934, DIN 125
4	Dichtung	EPDM		EN 681-1, BS 6920