

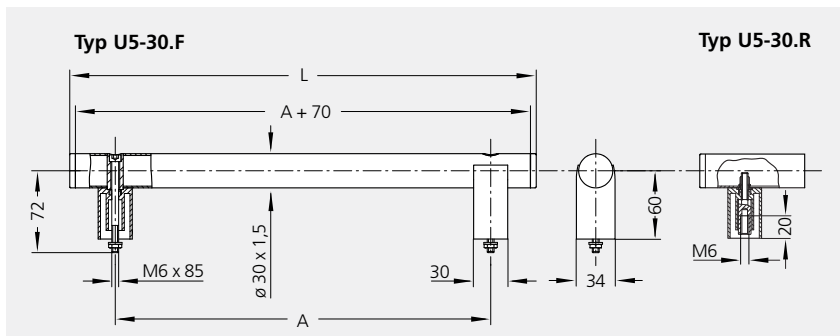

Typ U5-30.F



Typ U5-30.R



Griffe Handles

Rohre aus Aluminium Tubes made of aluminium

Rohre aus Edelstahl Tubes made of stainless steel

naturfarben
eloxiert
natural colour
anodized

schwarz pulver-
beschichtet
black powder
coated

feingeschliffen
fine ground

| Typ | A | L | Bestell-Nr. Order no. | Bestell-Nr. Order no. | Bestell-Nr. Order no. |
|---------|-----|-----|--------------------------|--------------------------|--------------------------|
| U5-30.F | 200 | 280 | U5-30.F200.01 | U5-30.F200.54 | U5-30.F200.37 |
| | 250 | 330 | U5-30.F250.01 | U5-30.F250.54 | U5-30.F250.37 |
| | 300 | 380 | U5-30.F300.01 | U5-30.F300.54 | U5-30.F300.37 |
| | 350 | 430 | U5-30.F350.01 | U5-30.F350.54 | U5-30.F350.37 |
| | 400 | 480 | U5-30.F400.01 | U5-30.F400.54 | U5-30.F400.37 |
| | 500 | 580 | U5-30.F500.01 | U5-30.F500.54 | U5-30.F500.37 |
| U5-30.R | 200 | 280 | U5-30.R200.01 | U5-30.R200.54 | U5-30.R200.37 |
| | 250 | 330 | U5-30.R250.01 | U5-30.R250.54 | U5-30.R250.37 |
| | 300 | 380 | U5-30.R300.01 | U5-30.R300.54 | U5-30.R300.37 |
| | 350 | 430 | U5-30.R350.01 | U5-30.R350.54 | U5-30.R350.37 |
| | 400 | 480 | U5-30.R400.01 | U5-30.R400.54 | U5-30.R400.37 |
| | 500 | 580 | U5-30.R500.01 | U5-30.R500.54 | U5-30.R500.37 |

Alle Maße in mm. / All dimensions in mm.

U5

Rohrgriffserie U5

Werkstoff und Oberfläche:

Rohre aus $\varnothing 30 \times 1,5$ mm
Aluminium AlMgSi 0,5;
naturfarben eloxiert oder
schwarz pulverbeschichtet mit
Feinstruktur. Alternativ aus
Edelstahl Werkstoff-Nr. 1.4301;
feingeschliffen.

Typ U5-30.F

Frontseitige Befestigung
mittels Zylinderschrauben aus
Edelstahl M6 x 85 DIN 912,
Muttern DIN 934 und Unter-
legscheiben DIN 125 (im Lie-
ferumfang enthalten).
Rohrhalter und Rohrkappe aus
Polyamid PA 6, glaskugelve-
stärkt, schwarz, halbmatt mit
Feinstruktur.

Typ U5-30.R

Rückseitige Befestigung über
verzinkten Stahleinsatz. Übrige
Bauteile wie Typ U5-30.F.

Tragkraft:

min. 1.000 N.

Hinweis:

Beliebige Griffängen auf An-
frage.

Tube Handle Series U5

Material and surface:

Tubes of $\varnothing 30 \times 1.5$ mm alu-
minium AlMgSi 0.5; natural
colour anodized or black pow-
dercoated with fine structure.
Alternatively, tube made of
stainless steel, material no.
1.4301; fine ground.

Typ U5-30.F

For front mounting by cylinder
head socket screws M6 x 85
DIN 912, nuts DIN 934 and
washers DIN 125 made of
stainless steel (included in
scope of supply).
Tube holders and tube caps
made of polyamide PA 6,
glass ball reinforced, black,
half-matt with fine structure.

Typ U5-30.R

For mounting from behind by
galvanized screw down insert
made of steel.

Stress resistance:

min. 1.000 N.

Note:

Any desired handle lengths on
request.