

Andruckspindel Inch

- Schwarzes, vulkanisiertes Neopren-Druckstück, labsfrei (Härte 70-80 Shore)
- Temperaturbeständig: -20°C bis 100°C [-22°F bis 212°F]
- Ölresistent, labs- (Silikon) frei
- Inkl. 2 Befestigungsmuttern
- Edelstahl-Version auf Anfrage verfügbar

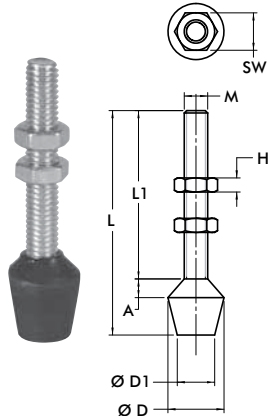

Andruckspindel Metrisch

- Rotes, vulkanisiertes Neopren-Druckstück, labsfrei (Härte 85 Shore)
- Temperaturbeständig: -20°C bis 100°C [-22°F bis 212°F]
- Ölresistent, labs- (Silikon) frei
- Inkl. 2 Befestigungsmuttern

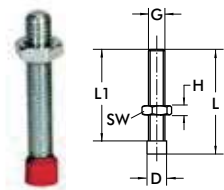
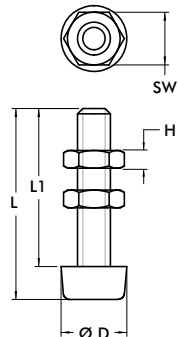
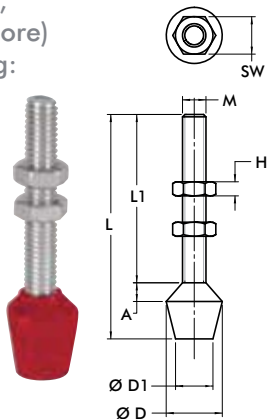

Art. Nr.	M	L	L1	SW	H	A	ØD	ØD1
102208	#8-32	[1.25] 31,8	[0.94] 23,8	[0.34]	[0.13] 3,2	[0.06] 1,6	[0.56] 14,3	[0.44] 11,1
105208		[1.00] 25,4	[0.69] 17,4	8,7		[0.13] 3,2		
201208	#10-32	[1.38] 35,1	[1.01] 25,5	[0.38] 9,5	[0.16] 4	[0.13] 3,2	[0.63] 16	[0.47] 12
202208	1/4-20	[1.63] 41,4	[1.08] 27,4	[0.44] 11,1		[0.12] 3		
215208		2.13] 54,1	[1.58] 40,1		[0.16] 4			
424208		[1.50] 38,1	[1.12] 28,5		[0.12] 3			
431208		[1.00] 25,4	[0.62] 15,8		[0.12] 3			
225208	5/16-18	[2.25] 57,2	[1.54] 39,1	[0.50] 12,7	[0.19] 4,8	[0.20] 5	[0.83] 21	[0.55] 14
507208		[3.00] 76,2	[2.29] 58,2	[0.19] 4,8	[0.83] 21		[0.55] 14	
240208	3/8-16	[3.25] 82,6	[2.31] 58,5	[0.56] 14,3	[0.22] 5,6	[0.20] 5	[1.02] 26	[0.79] 20
527208		[3.50] 88,9	[2.50] 63,5				[0.88] 22,2	[0.63] 16
235208		[5.75] 146,1	[4.77] 121,1				[1.02] 26	[0.79] 20
247208	1/2-13	[3.87] 98,3	[2.73] 69,3	[0.75] 19,1	[0.31] 7,9	[0.28] 7	[1.18] 30	[0.95] 24
267208	5/8-11	[5.00] 127	[3.63] 92,1	[0.94] 23,8	[0.38] 9,5	[0.38] 9,5	[1.38] 35,1	[1.00] 25,4

Art. Nr.	M	L	L1	SW	H	A	ØD	ØD1
431208-M	M6	[1.00] 25,4	[0.6] 15,8	[0.39] 10	[0.13] 3,2	[0.13] 3,3	[0.66] 16,8	[0.66] 16,8
424208-M		[1.63] 41,3	[1.25] 31,7					
202208-M		[1.73] 44	[1.18] 30					
215208-M	M8	[2.13] 54	[1.57] 40	[0.51] 13	[0.16] 4	[0.20] 5	[0.83] 21	[0.55] 14
225208-M		[2.09] 53	[1.38] 35					
2007208-M	M10	[2.48] 63	[1.77] 45	[0.67] 17	[0.20] 5	[0.20] 5	[0.83] 21	[0.55] 14
507208-M		[3.27] 83	[2.56] 65					
240208-M	M10	[3.11] 79	[2.17] 55	[0.67] 17	[0.20] 5	[0.20] 5	[1.02] 26	[0.78] 20
235208-M		[4.72] 120	[3.74] 95					
247208-M	M12	[4.02] 102	[2.87] 73	[0.75] 19	[0.24] 6	[0.28] 7	[1.18] 30	[0.94] 24

Art. Nr.	M	L	L1	SW	H	ØD
205208-M	M4	[0.87] 22	[0.79] 20	[0.28] 7	[0.09] 2,2	[0.32] 8
201208-M		[1.26] 32	[1.18] 30			
305208-M	M5	[1.14] 29	[0.98] 25	[0.32] 8	[0.11] 2,7	[0.39] 10
213208-M		[1.34] 34	[1.18] 30			
2013208-M		[1.54] 39	[1.38] 35			
307208-M	M8	[1.69] 43	[1.38] 35	[0.51] 13	[0.16] 4	[0.75] 19

Art. Nr.	D	L	L1	ØG
213208-M-L ^①	[0.24] 6	[1.34] 34	[1.18] 30	M5

① Lieferzeit auf Anfrage